

FITTING INSTRUCTIONS FOR MULTI-FIT BRACKET (HW-M/F)

Contents of pack: *(Pack contents are the same for Non-Permanent option)*

Part A: 1 x tube clamp (this is attached to the plastic mast pole)

Part B: 1 x 90 degree bracket with tube coupling with 4 x 15mm zinc plated screws and snap caps

Part C: 1 x 1.5m plastic mast pole.

Part D: 1 x J-Mould with 2 larger screws

There are 2 options of attaching this bracket to RV's

1. Permanent fit option

(will fit all types of RV's including pop tops, full height vans, motor homes, slide ons and campers)

Be aware at all times of electrical cable location in your RV when permanently fitting.

To permanently attach this bracket to the RV you start by drilling, (3.0mm), and screwing Part D (J Mould) as near as possible to the roof line to allow sufficient angle for Part C, the plastic mast pole to be fitted with the antenna head already fitted to the top of the pole. A minimum of 1 metre of pole should protrude above the roof-line.

Using bottom end of Part C (mast) as a guide, locate the correct fixing point for Part B on the RV wall. Remove Part C, drill, (3.0mm), and screw Part B to RV with snap caps to hide the screw head. Bottom of Part C (mast) drops into Part B, see Diagram 2. Refer to Diagram 1 for instructions on how to raise the antenna.

Whilst we provide screws for attaching, pop-riveting is a viable option. Also we recommend silicone sealing all holes prior to screwing or riveting.

It is advised to shorten mast to approximately 70cm above roof line for DX Active Zone Antenna. This allows for less movement in windy conditions and vertical reception.

Diagram 1

Mast is fitted with antenna already firmly attached. Part A is permanently attached to the mast and will slide up and down the pole (Part C) as required.

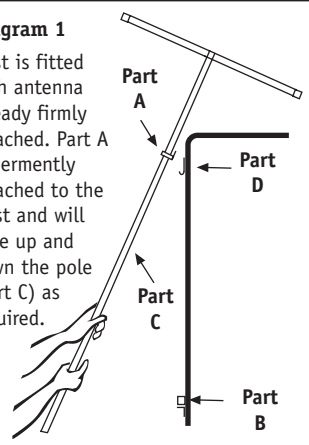

Multi-Fit Bracket
by Happy Wanderer
Registered Design No's
304316 & 304296
Australian Design
Application
Z1059/2007

Diagram 2

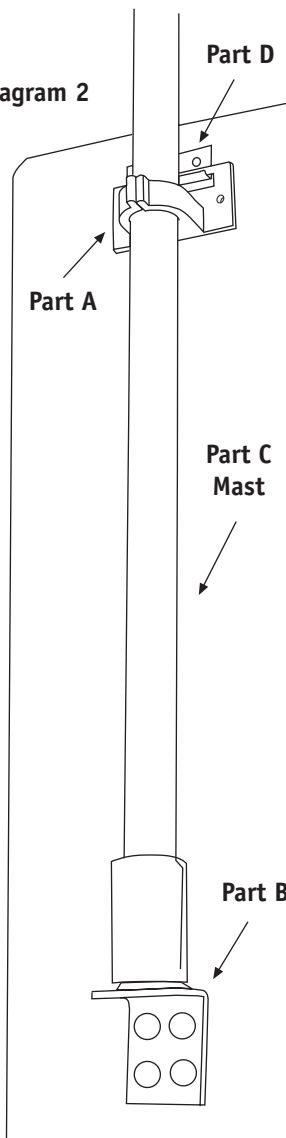

FITTING INSTRUCTIONS FOR MULTI-FIT BRACKET (HW-M/F)

2. Non-Permanent option

(Although the J-Mould (Part D), screws and snap caps are supplied, they are not needed for the non-permanent fitting described below)

Only for pop top vans and campers with side roof travel clamps fitted.

This option utilises the side roof travel clamp when the roof is lifted up. If the travel clamp is over 10cm from the top of the roof, fit the J-Mould supplied above it so that there is enough room to angle Part A, already fitted to the mast, with the antenna already attached into the J-Mould.

As with the permanent fitting described previously. The mast with Part A and the antenna head firmly attached is lifted into position onto the Van with the roof raised (see Diagram 1) and Part B is dropped into the travel clamp or Part D, J-Mould if fitted. The mast (Part C) with 90 degree bracket (Part B) attached to the bottom is dropped into position into the lower part of the existing travel clamp (see Diagram 4). The fitting may be loose at this lower fixing point. A tight fit is not necessary as Part A will not pull off the pole. The J-Mould (Part D) appears to be plastic but it is glass filled nylon and is very strong and corrosion resistant.

Note: For campervans with high lifting roof the Multi-fit extension mast, (sold separately), must be purchased.

It is advised to shorten mast to approximately 70cm above roof line for DX Active Zone Antenna. This allows for less movement in windy conditions and vertical reception.

Pop top roof on some vans may sag. If so you will need to make a strut to prevent sag. These are available from caravan accessory suppliers.

Diagram 4

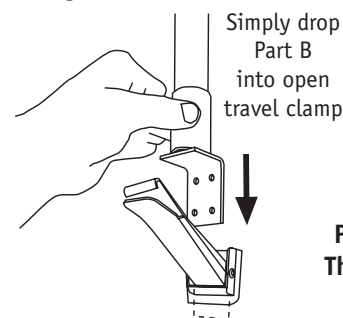
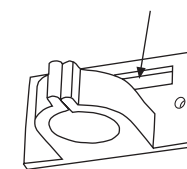

Diagram 5

Travel clamp (or J-mould) top locates in this gap



Part A tube clamp close up. This part is fixed to the mast before fitting.

Diagram 3

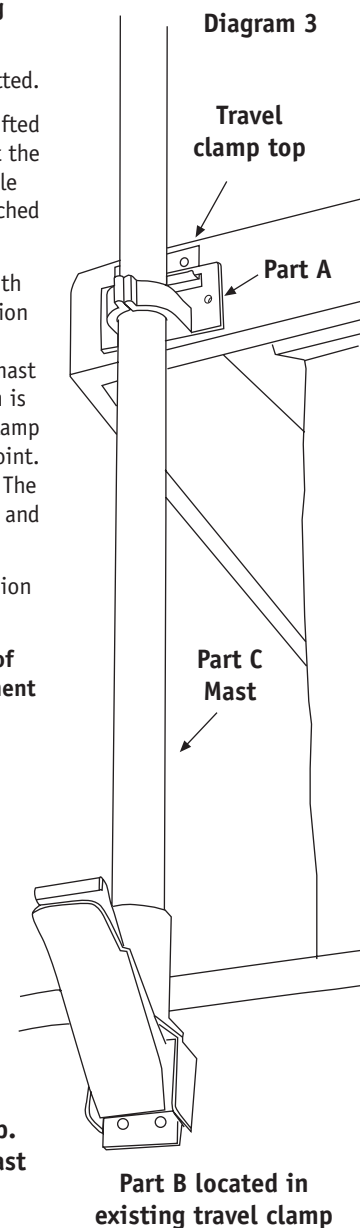

Part B located in existing travel clamp

THIS INSERT INCORPORATES NEW DESIGN CHANGES IN THIS PRODUCT. PLEASE REFER TO THESE INSTRUCTIONS.

"More information <https://www.caravansplus.com.au>"